

Future Land Use Plan The Town of Gorham

February 9, 2022 Draft

Map 2 of 2

Legend

- Proposed Trails
- Streams and Creeks
- State or US Routes
- County Roads
- Municipal Roads
- Private Drives
- Rezone to RR
- HC Change Area
- Potential Trail Opportunity Properties
- Municipal Boundaries
- Gorham Tax Parcels
- Tax Parcels outside Gorham
- FARMING PREFERRED/FARMLAND PRIORITY
- GENERAL BUSINESS
- HAMLET COMMERCIAL
- HAMLET RESIDENTIAL
- INDUSTRIAL
- PLANNED DEVELOPMENT
- PLANNED RESIDENTIAL DEVELOPMENT
- RURAL RESIDENTIAL
- SINGLE FAMILY RESIDENTIAL

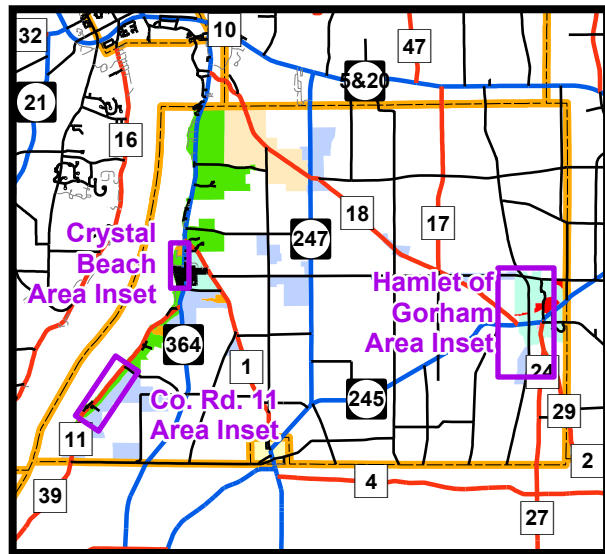

IMPORTANT NOTICE AND DISCLAIMER:
THIS MAP AND INFORMATION IS PROVIDED "AS IS" AND ONTARIO COUNTY MAKES NO WARRANTIES OR GUARANTEES, EXPRESSED OR IMPLIED, INCLUDING WARRANTIES OF TITLE, NON-INFRINGEMENT, MERCHANTABILITY AND THAT OF FITNESS FOR A PARTICULAR PURPOSE CONCERNING THIS MAP AND THE INFORMATION CONTAINED HEREIN. USER ASSUMES ALL RISKS AND RESPONSIBILITY FOR DETERMINING WHETHER THIS MAP IS SUFFICIENT FOR PURPOSES INTENDED.

County Road 11 Area Inset

Scale: 1:8,600

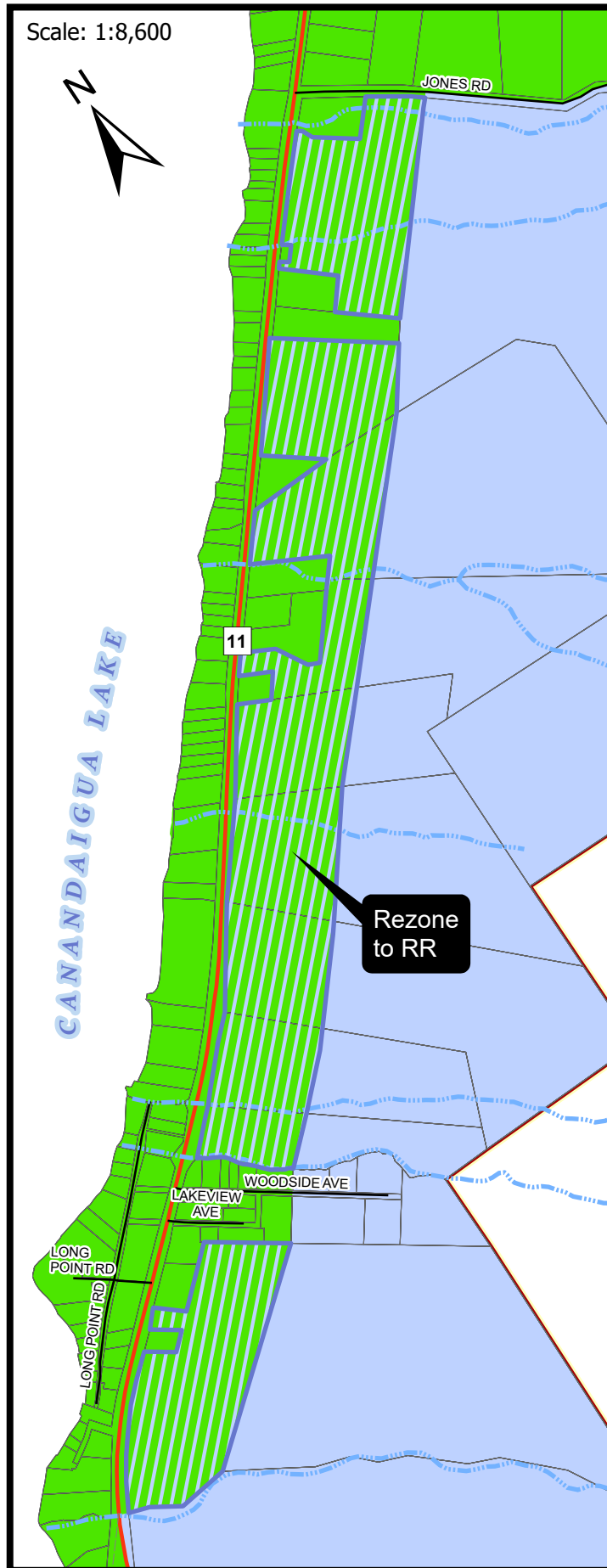

Source of Digital Tax Parcel Data: Copyright 2022 County of Ontario, All Rights Reserved, used by permission

Crystal Beach Area Inset

Scale: 1:5,400

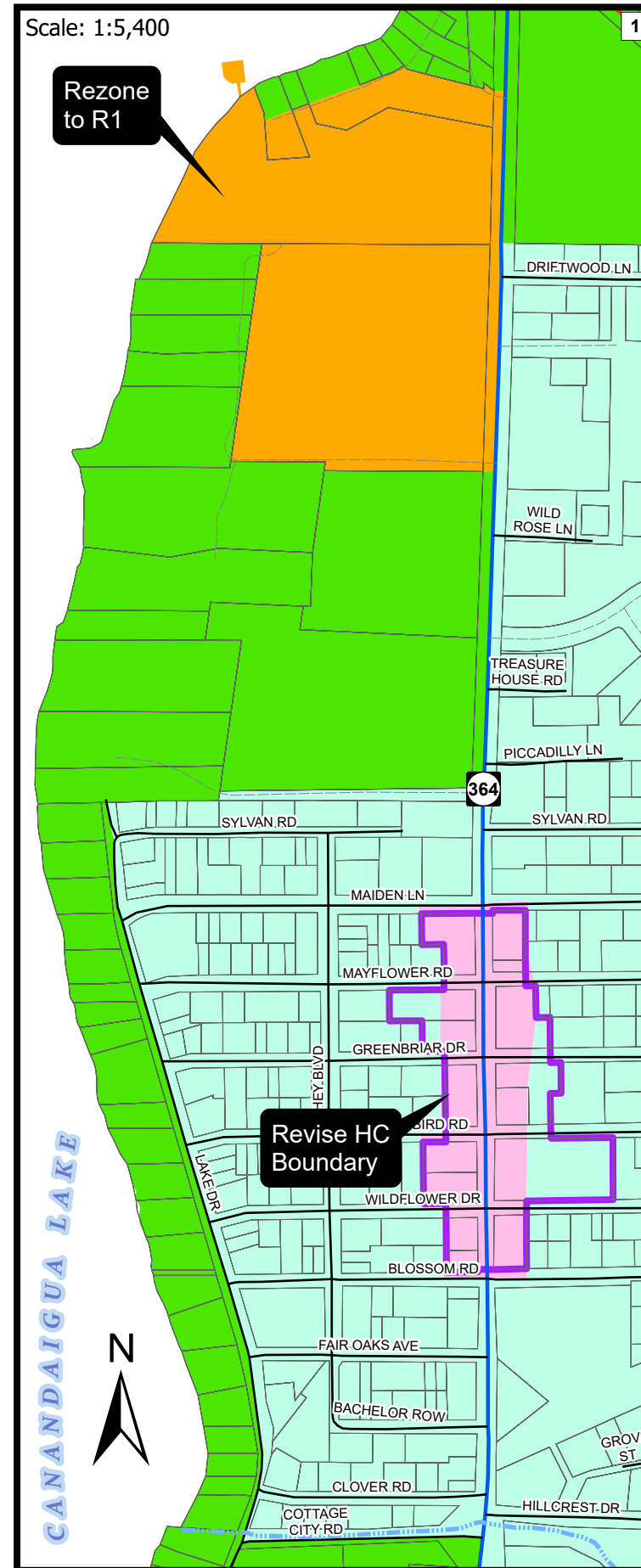

Source of Digital Zoning Data: 2013 County of Ontario, Planning Department, All Rights Reserved, used by permission

Hamlet of Gorham Area Inset

Scale: 1:13,000

